

LEGEND

SPECIAL FLOOD HAZARD
AREA WITH
DATE OF IDENTIFICATION



ZONE A
DATE

Note: These maps may not include all Special Flood Hazard Areas in the community. After a more detailed study, the Special Flood Hazard Areas shown on these maps may be modified, and other areas added.

CONSULT NFIA SERVICING COMPANY OR LOCAL INSURANCE AGENT OR BROKER TO DETERMINE IF PROPERTIES IN THIS COMMUNITY ARE ELIGIBLE FOR FLOOD INSURANCE.

INITIAL IDENTIFICATION DATE:

JUNE 25, 1976

DEPARTMENT OF HOUSING AND URBAN DEVELOPMENT
Federal Insurance Administration

FLOOD HAZARD BOUNDARY MAP H - 01-02

MAP INDEX
TOWN OF UPTON, WY
(WESTON CO.)

COMMUNITY NO. 560079

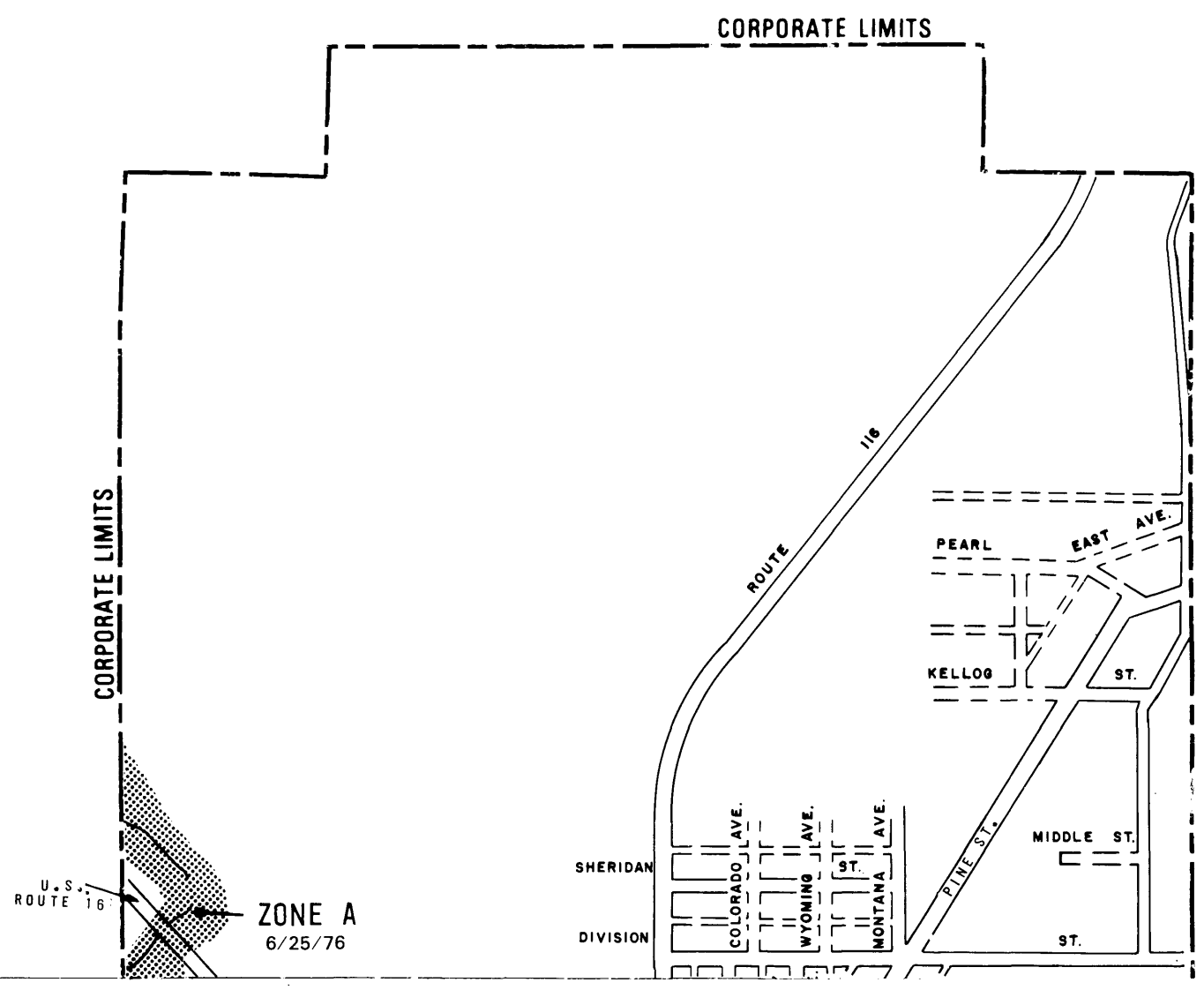

DEPARTMENT OF HOUSING AND URBAN DEVELOPMENT
Federal Insurance Administration

TOWN OF UPTON, WY
(WESTON CO.)

01

APPROXIMATE SCALE

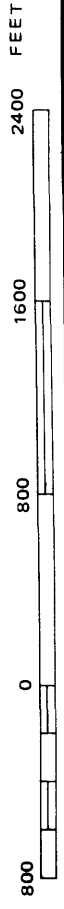

FLOOD HAZARD BOUNDARY MAP

EFFECTIVE DATE
6/25/76

JOINS 01

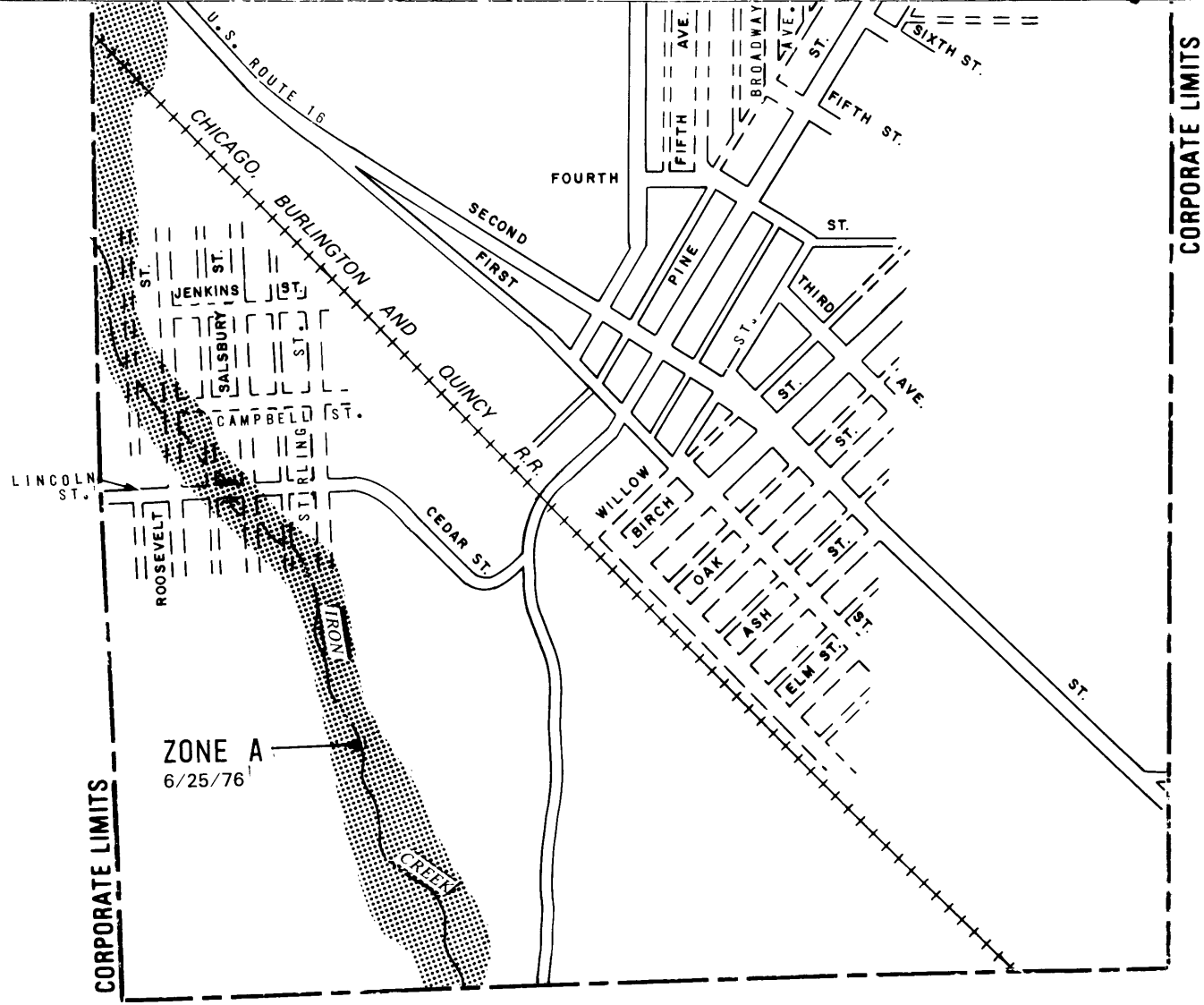

DEPARTMENT OF HOUSING AND URBAN DEVELOPMENT
Federal Insurance Administration

TOWN OF UPTON, WY
(WESTON CO.)

APPROXIMATE SCALE



FLOOD HAZARD BOUNDARY MAP

EFFECTIVE DATE
6/25/76