

LEGEND

SPECIAL FLOOD HAZARD
AREA

ZONE A

Note: These maps may not include all Special Flood Hazard Areas in the community. After a more detailed study, the Special Flood Hazard Areas shown on these maps may be modified, and other areas added.

TO DETERMINE IF FLOOD INSURANCE IS AVAILABLE IN THIS COMMUNITY, CONTACT YOUR INSURANCE AGENT, OR CALL THE NATIONAL FLOOD INSURANCE PROGRAM, AT (800) 638-8620, OR (800) 424-8872.

APPROXIMATE SCALE IN FEET
0 1000 2000

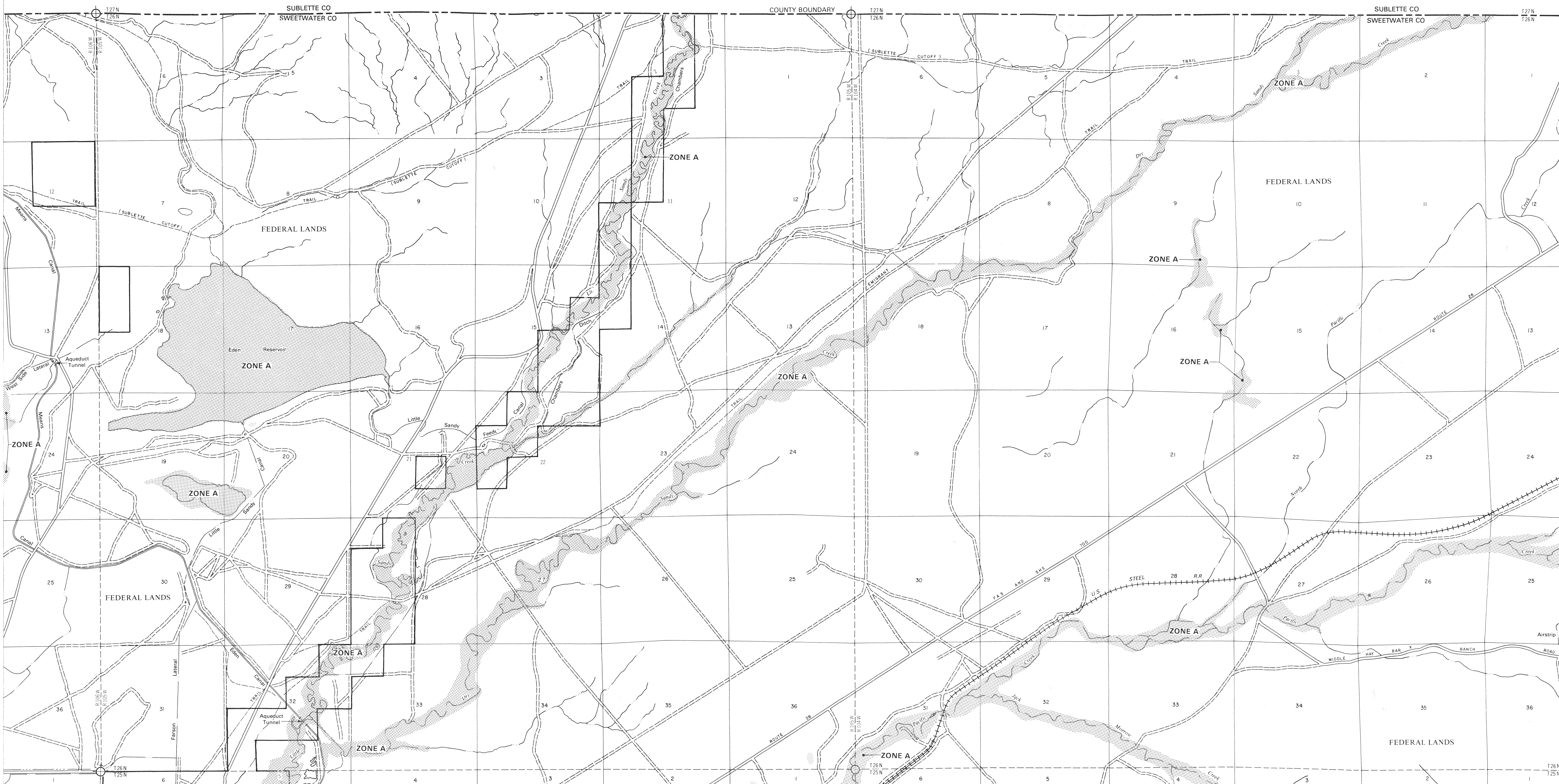

FLOOD HAZARD BOUNDARY MAP

**SWEETWATER COUNTY,
WYOMING**
UNINCORPORATED AREA
PAGE 4 OF 104
(SEE MAP INDEX FOR PAGES NOT PRINTED)

EFFECTIVE DATE:
AUGUST 1, 1978

COMMUNITY - PANEL NO.
560087 0004 A



U.S. DEPARTMENT OF HOUSING
AND URBAN DEVELOPMENT
FEDERAL INSURANCE ADMINISTRATION