

**LEGEND**

**SPECIAL FLOOD HAZARD AREAS INUNDATED BY 100-YEAR FLOOD**

**ZONE AE** No base flood elevations determined.

**ZONE AH** Base flood elevations determined.

**ZONE AO** Flood depths of 1 to 3 feet (usually areas of ponding); base flood elevations determined.

**ZONE A99** Flood depths of 1 to 3 feet (usually areas of ponding); base flood elevations determined. For areas of alluvial fan flooding; vehicles also determined.

**ZONE V** To be protected from 100-year flood by Federal flood protection system under construction; no base flood elevations determined.

**ZONE VE** Coastal flood with velocity hazard (wave action); base flood elevations determined.

**FLOODWAY AREAS IN ZONE AE**

**OTHER FLOOD AREAS**

**ZONE X** Areas of 500-year flood; areas of 100-year flood with average depths of less than 1 foot or with drainage areas less than 1 square mile; and areas protected by levees from 100-year flood.

**OTHER AREAS** Areas determined to be outside 500-year floodplain.

**ZONE D** Areas in which flood hazards are undetermined.

**UNDEVELOPED COASTAL BARRIERS\***

Identified 1983      Identified 1990      Otherwise Protected Areas

\*Coastal barrier areas are normally located within or adjacent to special flood hazard areas.

Floodplain Boundary  
Floodway Boundary  
Zone D Boundary  
Boundary Dividing Special Flood Hazard Zones, and Boundary Dividing Areas of Different Coastal Base Flood Elevations Within Special Flood Hazard Zones.

513  
Base Flood Elevation Line; Elevation in Feet\*

(EL 987)  
Cross Section Line  
Base Flood Elevation in Feet Where Uniform With Zone\*

RM 7.4  
Elevation Reference Mark

+M1.5  
River Mile

\*Referenced to the National Geodetic Vertical Datum of 1929

**NOTES**

This map is for use in administering the National Flood Insurance Program. It does not necessarily identify all areas subject to flooding, particularly from local drainage sources of small size, or all planning features outside Special Flood Hazard Areas. The community map repository should be consulted for more detailed data on BFEs, and for any information on floodway delineations, prior to use of this map for property purchase or construction purposes.

Areas of Special Flood Hazard (100-year flood) include Zones A, AE, A1-A30, AH, AO, A99, V, VE, and X.

Certain areas not in Special Flood Hazard Areas may be protected by flood control structures.

Boundaries of the floodways were computed at cross sections and interpolated between cross sections. The floodways were based on hydraulic considerations with regard to requirements of the Federal Emergency Management Agency.

Floodway widths in some areas may be too narrow to show to scale. Refer to Floodway Data Table where floodway width is shown at 1/200 inch.

Coastal base flood elevations apply only landward of 0.0 NGVD, and include the effects of wave action; these elevations may also differ significantly from those developed by the National Weather Service for hurricane evacuation planning.

Corporate limits shown are current as of the date of this map. The user should contact appropriate community officials to determine if corporate limits have changed subsequent to the issuance of this map.

MAP REPOSITORY  
Town Clerk  
145 Cotton Street  
Ranchester, Wyoming 82801  
(Maps available for reference only, not for distribution.)

INITIAL IDENTIFICATION:  
SEPTEMBER 6, 1974

FLOOD HAZARD BOUNDARY MAP REVISION:  
MARCH 12, 1976

FLOOD INSURANCE RATE MAP EFFECTIVE:  
APRIL 15, 1988

FLOOD INSURANCE RATE MAP REVISIONS:  
Map revised January 20, 1999 to update corporate limits, to add base flood elevations, to add special flood hazard areas, and to add roads and river names.

To determine if flood insurance is available in this community, contact your insurance agent or call the National Flood Insurance Program at (800) 638-6620.

APPROXIMATE SCALE IN FEET

0 500 500

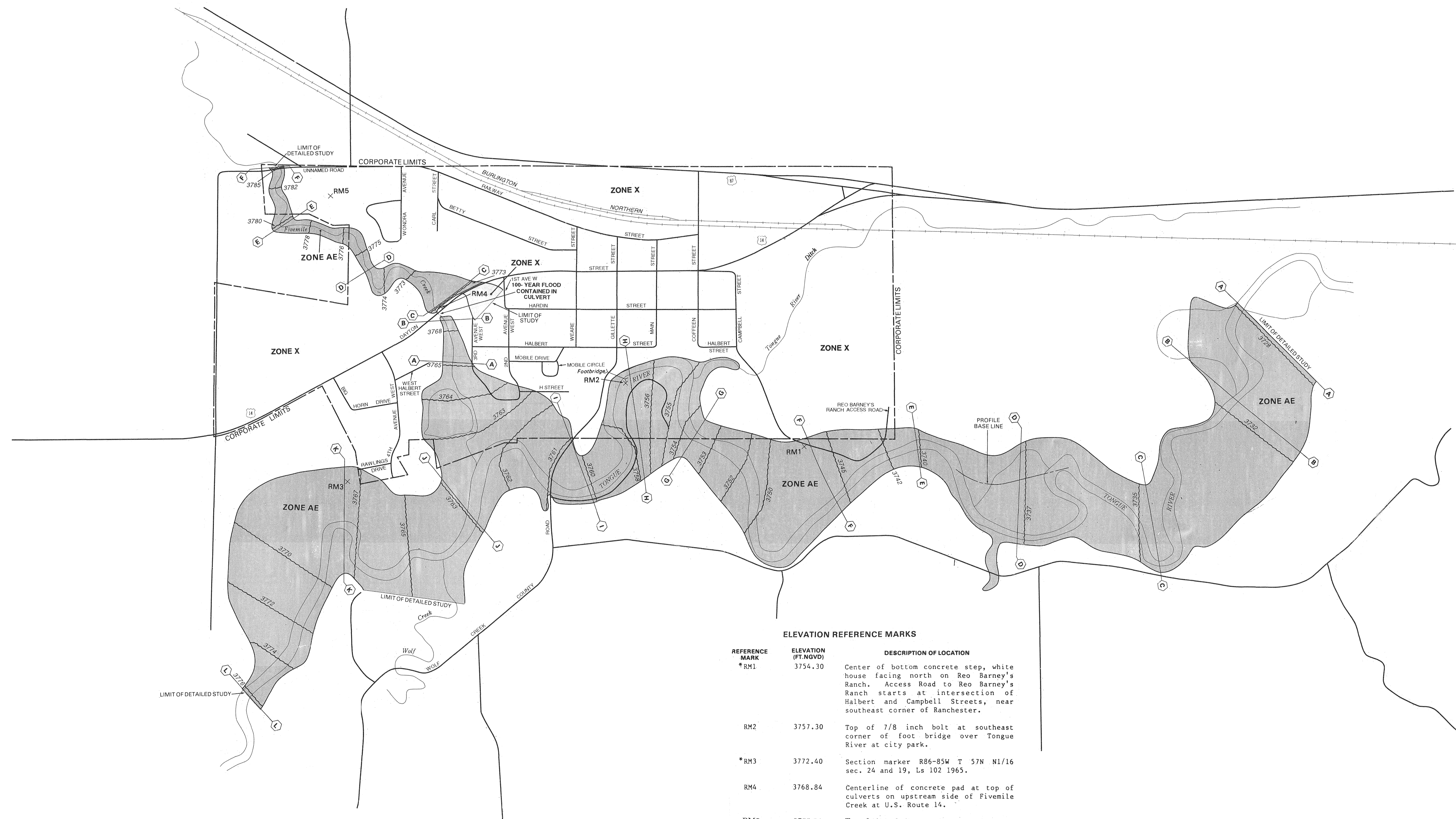

**ELEVATION REFERENCE MARKS**

REFERENCE MARK	ELEVATION (FT. NGVD)	DESCRIPTION OF LOCATION
*RM1	3754.30	Center of bottom concrete step, white house facing north on Reo Barney's Ranch. Access Road to Reo Barney's Ranch starts at intersection of Halbert and Campbell Streets, near southeast corner of Ranchester.
RM2	3757.30	Top of 7/8 inch bolt at southeast corner of foot bridge over Tongue River at city park.
*RM3	3772.40	Section marker R86-95W T 57N N1/16 sec. 24 and 19, Is 102 1965.
RM4	3768.84	Centerline of concrete pad at top of culverts on upstream side of Fivemile Creek at U.S. Route 14.
RM5	3783.64	Top of 1/4 inch diameter by 10 inch long landscaping spike in private drive located approximately 180 feet west of the east section line of Section 13, R86W, T57N, and approximately 295 feet south of the north line of the southeast quarter of the southeast quarter of Section 13, R86W, T57N.

\*LOCATED OUTSIDE CORPORATE LIMITS

Flood hazard information shown within Sheridan County, unincorporated areas is shown for information purposes only. For flood insurance purposes, refer to separately published Flood Insurance Rate Map for Sheridan County.

**NATIONAL FLOOD INSURANCE PROGRAM**

**FIRM FLOOD INSURANCE RATE MAP**

TOWN OF RANCHESTER WYOMING SHERIDAN COUNTY

ONLY PANEL PRINTED

COMMUNITY-PANEL NUMBER 560046 0001 C

MAP REVISED: JANUARY 20, 1999

Federal Emergency Management Agency