



**LEGEND**

**SPECIAL FLOOD HAZARD  
AREA WITH  
DATE OF IDENTIFICATION**



Note: These maps may not include all Special Flood Hazard Areas in the community. After a more detailed study, the Special Flood Hazard Areas shown on these maps may be modified, and other areas added.

CONSULT NFIA SERVICING COMPANY OR LOCAL INSURANCE AGENT OR BROKER TO DETERMINE IF PROPERTIES IN THIS COMMUNITY ARE ELIGIBLE FOR FLOOD INSURANCE.

INITIAL IDENTIFICATION DATE:  
**MARCH 29, 1974**

REVISION DATES:  
8/8/76 : SHOW CURVILINEAR BOUNDARY, ADD SFHA,  
REDUCE SFHA, CHANGE COMMUNITY  
BOUNDARY.

CONVERTED BY LETTER  
EFFECTIVE 9/1/99

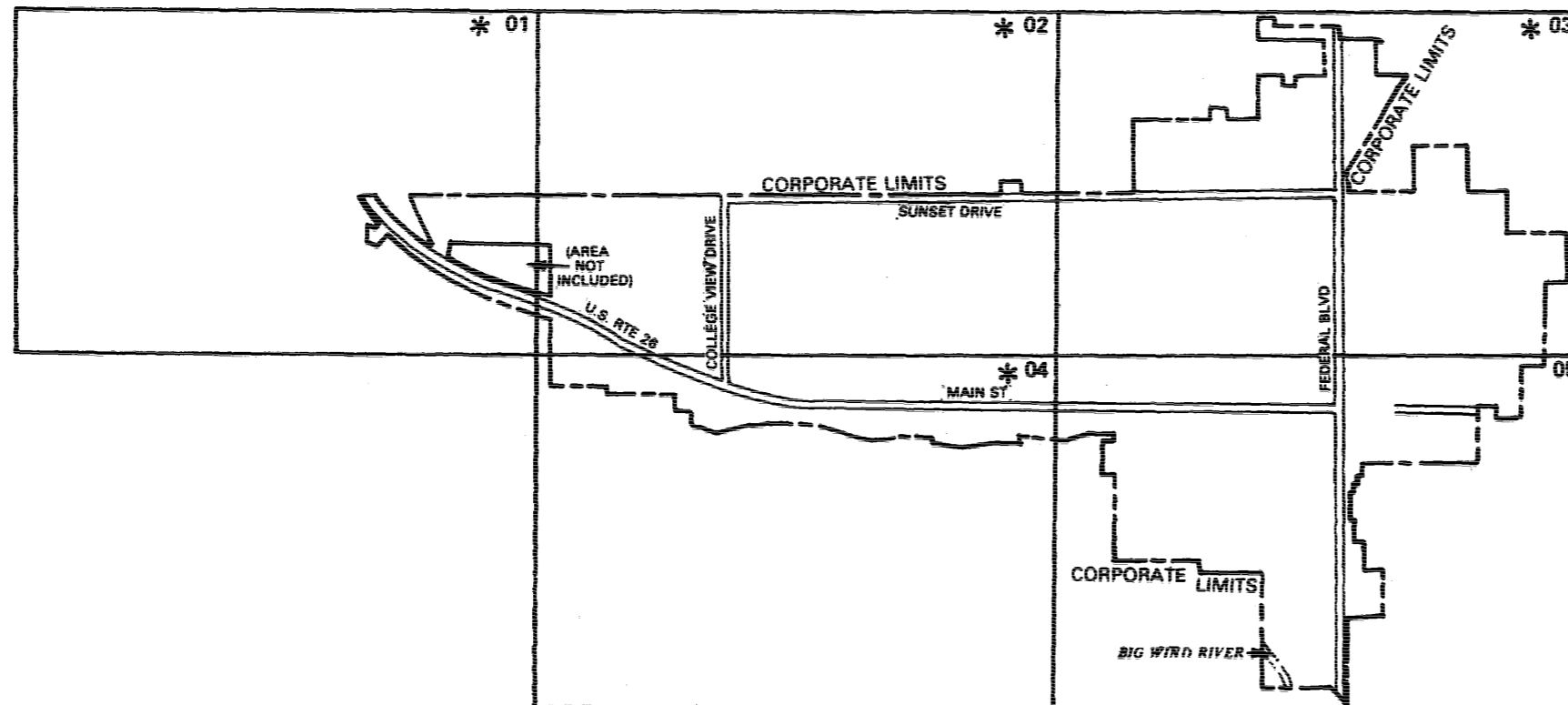

\*NOT PRINTED (NO SPECIAL FLOOD HAZARD AREA)

DEPARTMENT OF HOUSING AND URBAN DEVELOPMENT  
Federal Insurance Administration

FLOOD HAZARD BOUNDARY MAP H - 01-05

MAP INDEX

**CITY OF RIVERTON, WY**  
(FREMONT CO.)

COMMUNITY NO. 560021A

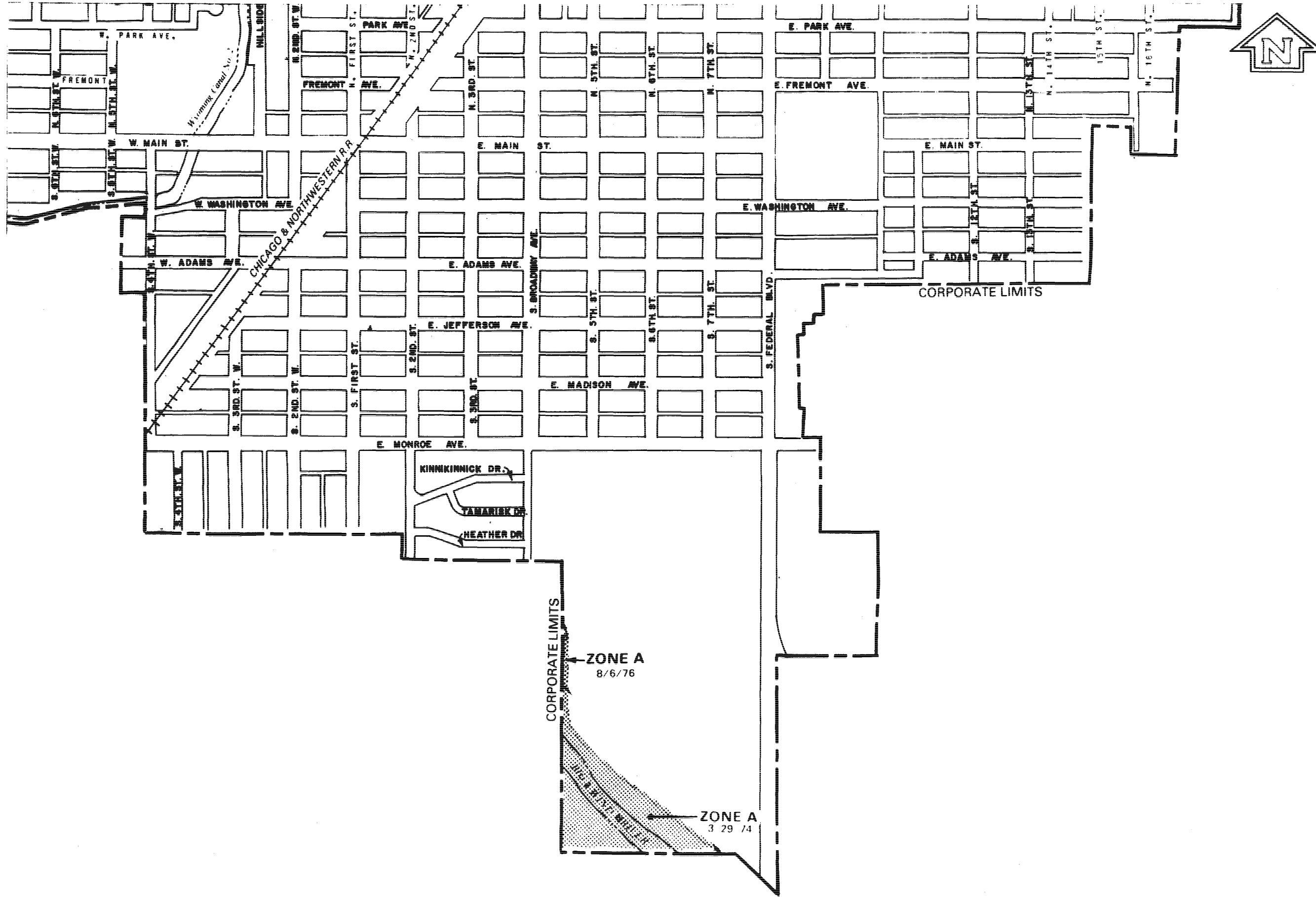

APPROXIMATE SCALE

1800 FEET

1200

600

0

600

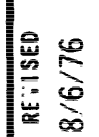

MAP REVISED 8/6/76

# FLOOD HAZARD BOUNDARY MAP

DEPARTMENT OF HOUSING AND URBAN DEVELOPMENT  
Federal Insurance Administration

## CITY OF RIVERTON, WY

(FREMONT CO.)